



# STUDIO

1 bedroom/1 bath  
~573 sq.ft.

## IMPECCABLY CURATED FLOORPLANS:

- Lofty 10' Ceilings
- Oversized, low-e windows offering abundant natural light
- Impressive Floor to Ceiling Windows
- Unique Wood finished Dress-In Closets\*
- Contemporary wine cooler/bar, floating shelves with USB charging stations
- Elevated 8' Entry Doors
- Vintage Wood Inspired Flooring\*
- Gorgeous Quartz Countertops
- Sleek White European Style Cabinetry
- Designer Pendant Lighting\*
- Dynamic Energy Star Appliances\*
- Superbly designed Built-In Pantries\*
- Decorative Tiled Backsplash\*
- State of the Art Smart Home Technology\*
- Spa Inspired Tiled, Stand-In Frameless Showers\*
- Roomy Linen Closets\*

\*Select homes only

## AMENITIES:

- Walk Score of 81- a pedal and pedestrian friendly environment where errands may be accomplished on foot
- Pedestrian to the coveted Devine Street Corridor, including exquisite shopping, great food, culture and entertainment
- Convenient Elevator
- Rubbish Room
- Contemporary Indoor/Outdoor kitchen and entertaining area
- Private controlled building access
- Beautifully curated landscaping
- Pet Friendly
- Gorgeous entry and mail room area
- Meticulously curated corridors
- Convenient bike parking
- The House
- Enchanted Rooftop
- Fiber availability
- Accessible Onsite Parking

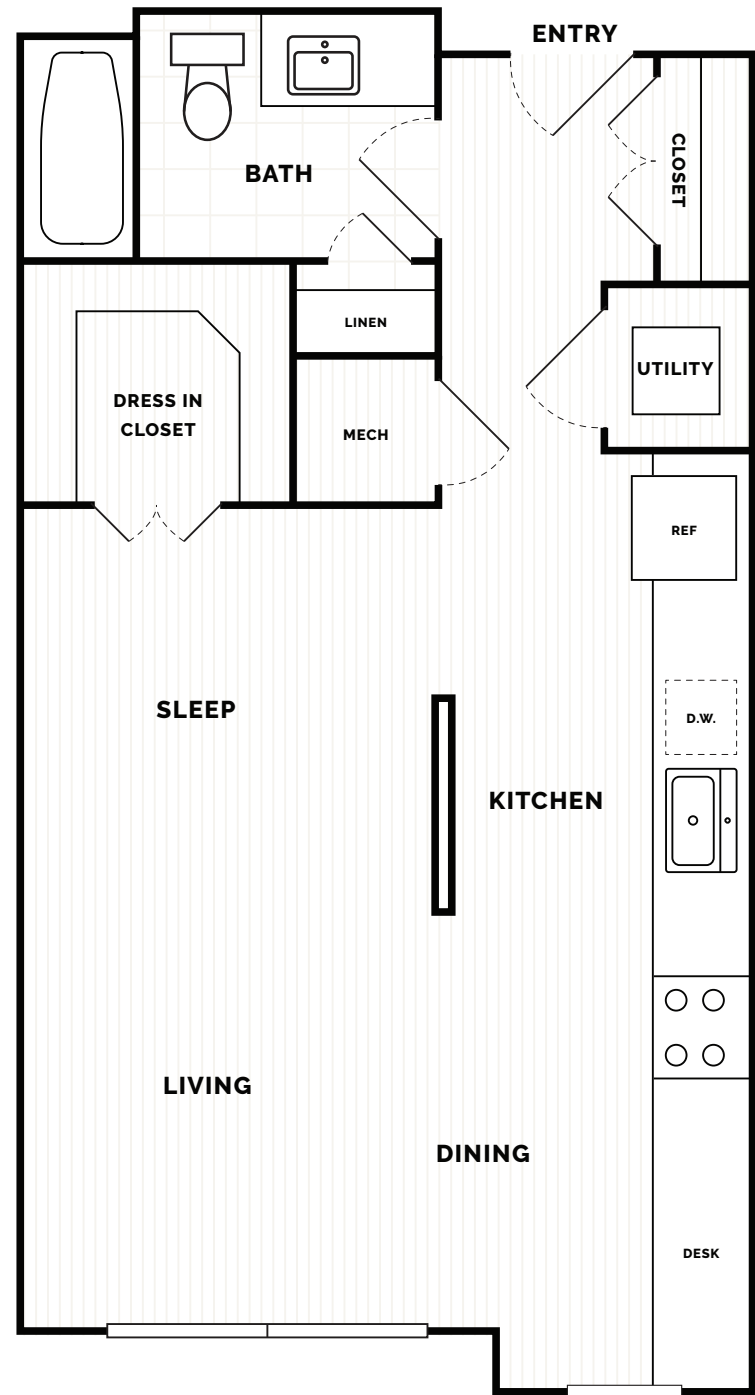

The Developer, its successors, or assigns reserve the right without notice to any purchaser or respective purchasers, to alter or modify preliminary plans, specifications, prices, materials, finishes, standard features, upgrade features, and other descriptions of the project including amenities, restrictions, and any other matters that may affect the project and unit ownership. Photographs, renderings, and other depictions are illustrative and conceptual only. All renderings are illustrative only and are subject to change. Plans are preliminary and are not to scale. Square footage is approximate and should not be relied upon as a representation, express or implied. Floor plans may vary per residence, elevation, type, and may be in mirror image. Unit does not include washer, dryer, furniture, or furnishings.